

SPECIFICATII PENTRU DIN 316 , SURUB FLUTURE

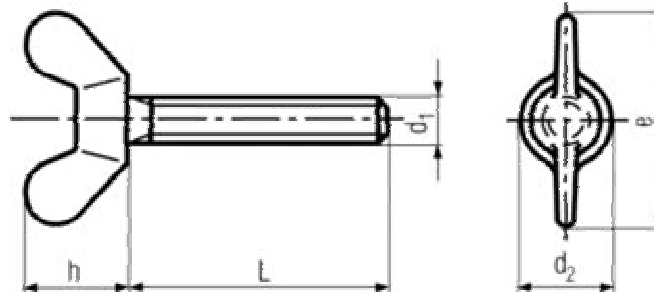

ROCAST

Toate masuratorile sunt in milimetri (mm)

d	h	e	d ₂
M4	8.5	18	6
M5	11	24	8
M6	15	30	10
M8	18	36	13
M10	23	48	17
M12	31	62	20
M16	35	70	26